

Elevator & Building Directory

Sarasota Memorial Hospital Campus

Elevator 'A' Waldemere Parking Garage		Elevator 'D' East Tower	
3	Waldemere Medical Plaza Bridge	1	Radiology
Elevator 'B' Waldemere Tower		1	Meckler Center
2	Endoscopy	1	1700 South Cafe
2	Wound Care	2	Cardiac Cath Lab
3	Infection Control	2	Labor & Delivery
4	Hyperbaric/Respiratory	2	Neonatal Intensive Care
4	Cafeteria	4	Echo/Vascular/Nuclear Med
5	Rooms 530-548	5	Rooms 565-599
6	Rooms 630-648	6	Rooms 664-699
7	Rooms 730-748	7	Rooms 764-799
8	Rooms 830-848	8	Rooms 864-899
9	Rooms 930-948	9	Rooms 965-999
10	Rooms 1030-1048	10	Rooms 1065-1077
Elevator 'C' Central Hallway		Elevator 'G' Critical Care Tower	
2	Center for Advanced Surgery	1	Emergency Care Center
3	Rooms 327-343	2	Surgery: Phase 2 Recovery, Post-Anesthesia, Cabana, Perioperative Services, Wave, Surgical Waiting Room
4	Rooms 427-443		
5	Employee Health		
Waldemere Medical Plaza		3	Laboratory
1	Breast Health Center	4	Women's & Minimally Invasive Surgery Center, ICU/Surgery Waiting Room
1	Dialysis		
2	Outpatient Laboratory	5	Intensive Care Unit (ICU) & Waiting Room
2	Walgreens Pharmacy		
2	Auditorium & Conference Rooms		
3-8	Medical Offices	6	Dialysis (6CC)



Emergency & Outpatient Surgery

Directions & Information

Directions for Emergency & Outpatient Surgery Patients:

- ▶ To drive to Sarasota Memorial Hospital's Emergency Care Center, turn west at the traffic light at South Tamiami Trail/U.S. 41 and Waldemere Street.
- ▶ Make the first left turn in front of the hospital, and follow the signs to the canopied Emergency Entrance.
- ▶ The Emergency Entrance has free valet parking, as well as curbside drop-off and pick-up for your convenience.
- ▶ Patients undergoing outpatient surgery in the hospital should also use the Emergency Entrance.
- ▶ Please pardon our construction while we improve the hospital campus! Hospital staff are happy to provide directions and assistance.

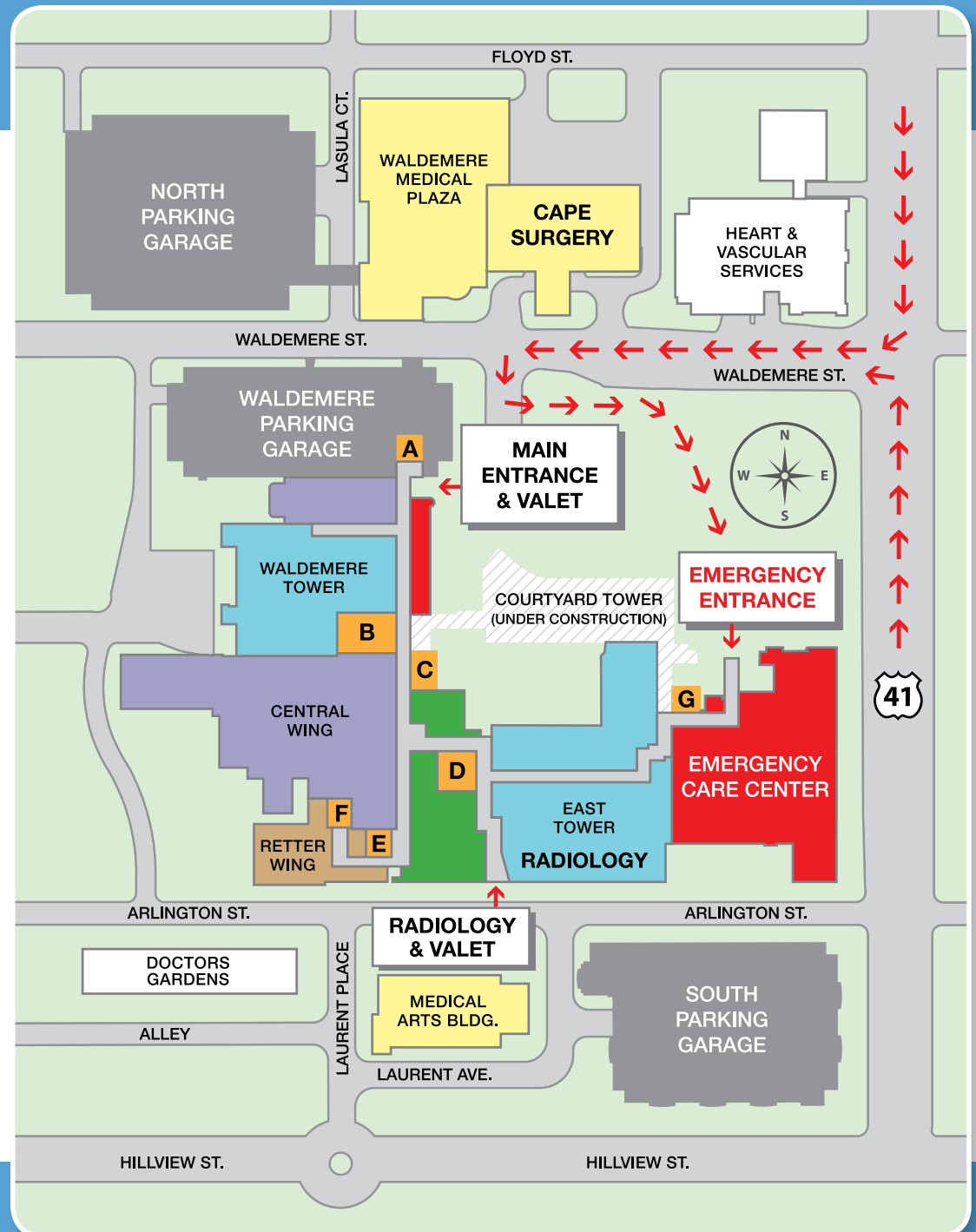

Patient Pick Up

Directions & Information

Directions to Pick Up Patients After Their Hospital Stay:

- ▶ Discharge Services facilitates all patient discharges from the hospital. This may include time in the Discharge Lounge as patients wait for a ride.
- ▶ Discharge Services is located on the first floor, around the corner from the 'D' Elevators and 1700 South Café. Contact the Discharge Services office at 917-1990 (*dial 1990 from any hospital phone*).
- ▶ Discharge staff will transport patients to the Radiology Entrance on Arlington Street to meet their rides.
- ▶ Drivers may pick up patients under the large Blue Canopy on Arlington Street.
- ▶ A valet will be available to assist you.

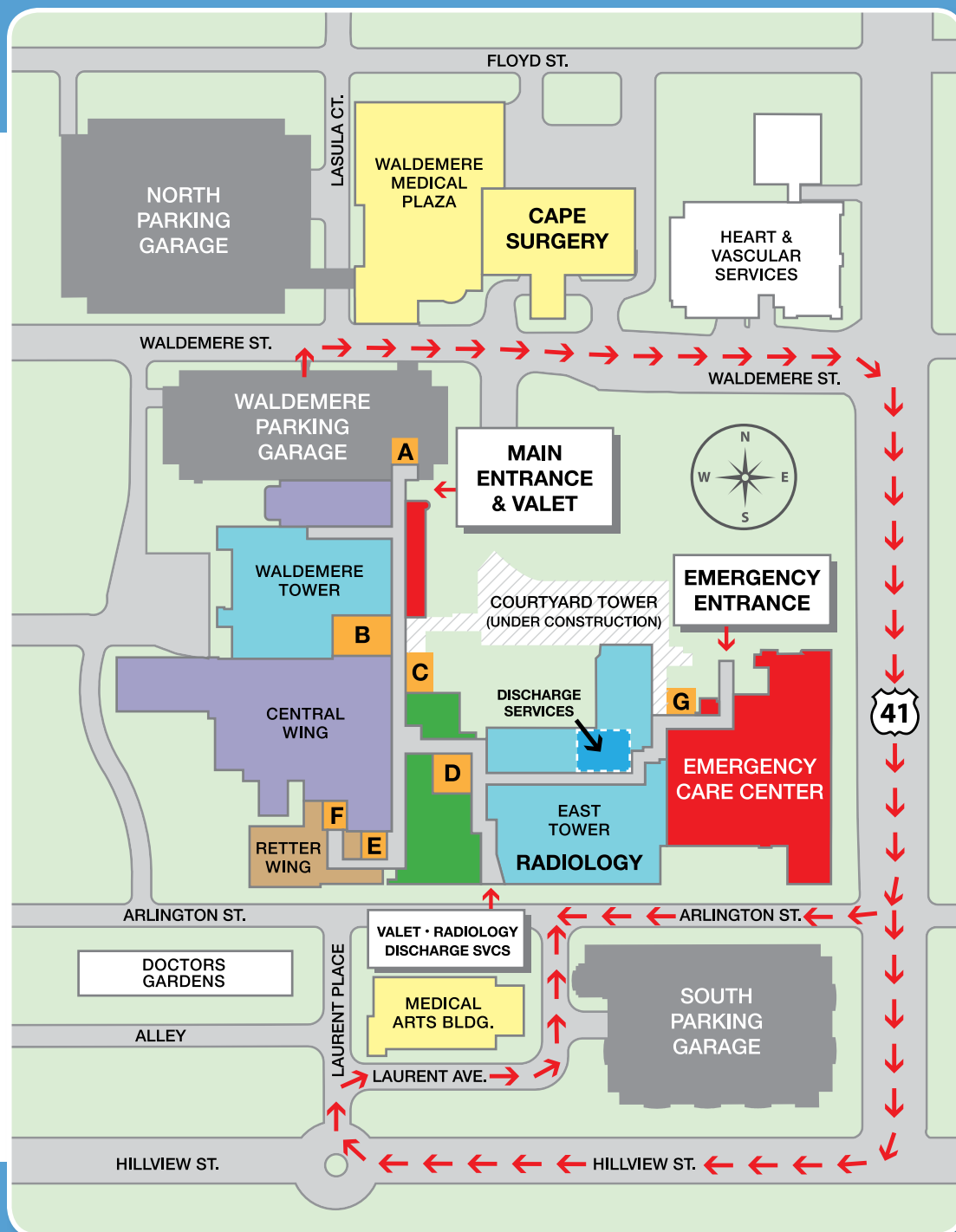

Surgery Patients

Directions & Information

Check-In Monday through Friday, 5 am - 8 pm:

- ▶ Please report to the Main Lobby Information Desk. Our Information Desk staff will instruct you where to go.
- ▶ To bypass this step, patients scheduled for surgery may be dropped off at the entrance of the Emergency Care Center. Take the G Elevator (located next to the Emergency Care Center waiting room) to the Surgery Reception Center on the second floor.

Check-In on Weekends and Holidays:

- ▶ Arriving before 8 am, please report directly to the Emergency Care Center for further directions.
- ▶ Arriving after 8 am, please check in at the Main Lobby Information Desk.

Check-In for Orthopedic Patients, Weekends Only:

- ▶ If you are undergoing hip, knee, or joint surgery over the weekend, please take the C Elevator to the third or fourth floor, and check in at the Orthopedic Unit Nurse's Station.

Parking & Patient Pick Up:

- ▶ Self-parking is free at all hospital garages, including Waldemere Garage.
- ▶ Valet parking is available weekdays 5am - 8pm, at the Main Entrance.
- ▶ Discharged patients may be picked up at the Radiology Entrance on Arlington Street under the blue canopy. A valet is available there to assist patients & guests.

